

SST-7000

SST-7100

Speed Switch / Transmitter

- Accepts 2 or 3-wire speed sensors
- 0 - 50 KHz input frequency range
- 4 – 20 mA output (isolated)
- 0 – 5 / 0 – 10 VDC linear output
- 50 msec relay response time (SST7100)
- Failed (open) pickup sensing
- Square wave repeater output
- 10 – 36 VDC input supply power
- Available input isolation transformer
- PC programmable



The SST-7000 series accepts a pulsed input and provides an extremely accurate 4 – 20 mA output representing speed of rotating machinery for a local panel meter or PLC analog input card. The SST-7100 also provides a quick relay response to over / under speed conditions. Applications include speed measurement & overspeed protection of industrial engines, turbomachinery and pumps.

SPECIFICATIONS

Electrical:

- Supply Voltage: 10 – 36 VDC, maximum 5 Watts
- Input Types: 2-wire magnetic pickup (variable reluctance)
Dynalco models M201, M202, M231, M233, M203, M204 & M205
3-wire Hall-Effect
Dynalco model M951
3-wire amplified VR type
Dynalco models M928 & M928-24
- Input Sensitivity: 25 mV min – 50 VRMS max
- Proportional Output: Fully isolated 4 – 20 mA (sourced)
Plus 0 – 5 VDC or 0 – 10 VDC
- Relay (SST-71000): SPDT contacts rated 6 Amps at 28 VDC or 115 VAC

Mechanical:

- DIN rail mount (standard 35 mm)
- Removable connectors

Environmental:

- 40 to +70 DegC operating temperature range

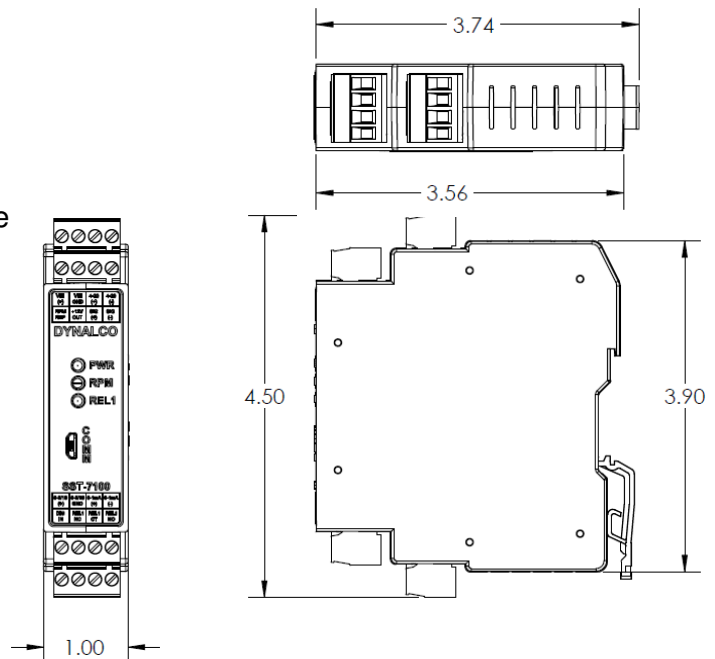
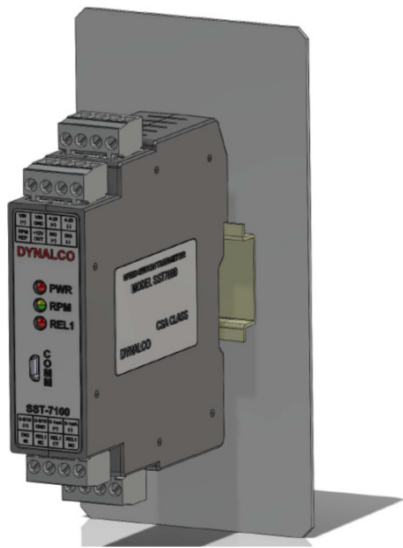

HOW TO ORDER

Specify part number as follows:

- | | |
|-----------|--|
| SST7000 | transmitter only |
| SST7000-I | transmitter w/ isolated input |
| SST7100 | transmitter / 1 setpoint |
| SST7100-I | transmitter / 1 setpoint w/ isolated input |